

Dedicated to People Flow™



SOPHISTICATED ELEVATOR ENVIRONMENTS

KONE Design Collection



KONE Design Collection –

when every detail counts

A new user experience

For KONE, the goal is to create the best possible user experience. A smooth ride and reliable performance ensure the ideal people flow, while the car interior design creates an aesthetically pleasing experience for each passenger.

There is more to this than mixing and matching the materials and components. The quality of materials, manufacturing process and assembly have to be first class to ensure that everything including the energy-efficient lighting, innovative car operating panels and material combinations always supplement any type of architecture.

KONE has enhanced the lighting level, met the accessibility codes and fulfilled the environmental requirements. With these standards as our base complemented by finishes available within this Design Book, KONE has created complete harmony where all parts work together. The end result generates a positive user experience: aesthetically, functionally and emotionally.

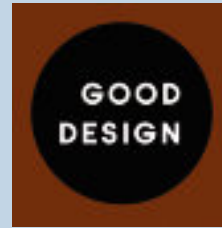

The KONE Design Collection received the GOOD DESIGN award for its innovative elevator design concept by The Chicago Athenaeum: Museum of Architecture and Design. KONE is the first elevator and escalator company to ever receive this prestigious award.

KONE's FourSeasons™ concept is part of the innovative KONE Design Collection which combines different colors and shades reflecting the seasons, making it easier and faster for a customer to select a sophisticated and stylish design. Over 70 specially designed alternatives offer hundreds of different possibilities to match any interior and architecture.

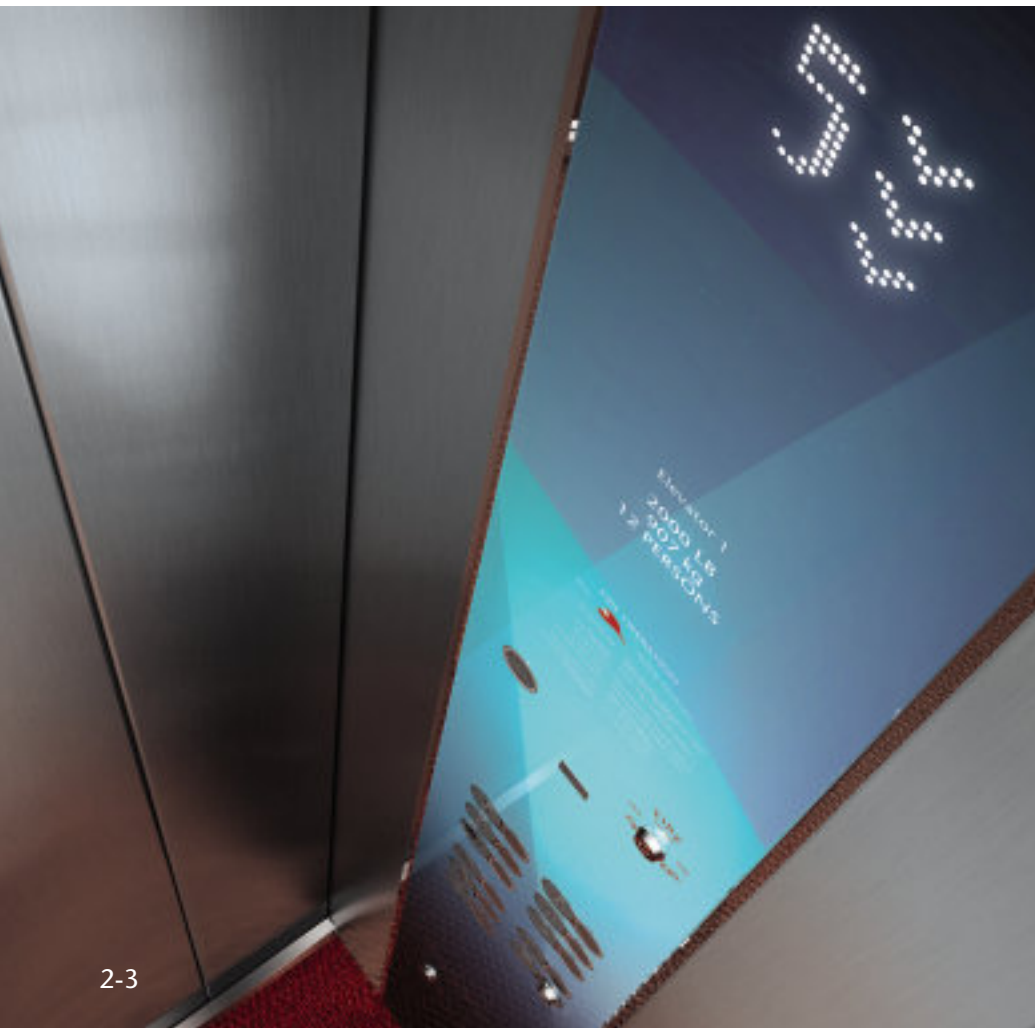

Mix & Match

If you can't find exactly what you're looking for from our KONE Design Collection interiors, you can replace elements with alternatives from the range. Select ceilings, walls, doors, handrails and flooring. There are thousands of possible combinations.

The possibilities are virtually limitless

Executive Custom Car Offering

KONE Executive, available for MonoSpace® and EcoSystem MR™, rises to the top floor in sophistication and performance. White marble in the lobby floor? Walnut paneling in the executive suite? Design a unique custom elevator interior to match the décor of your building. Choose the material and we'll build an elevator.



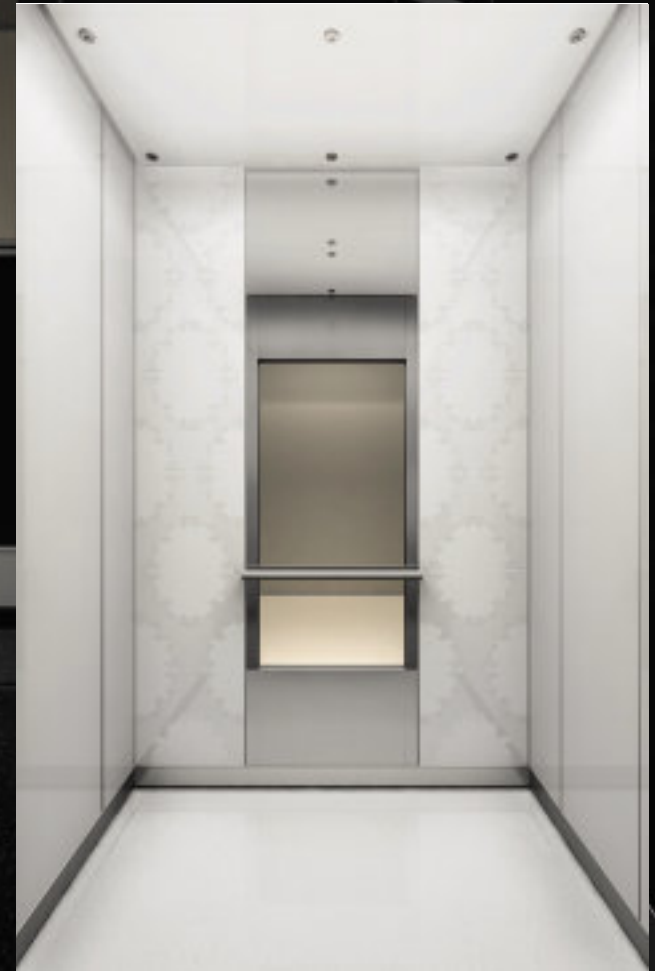
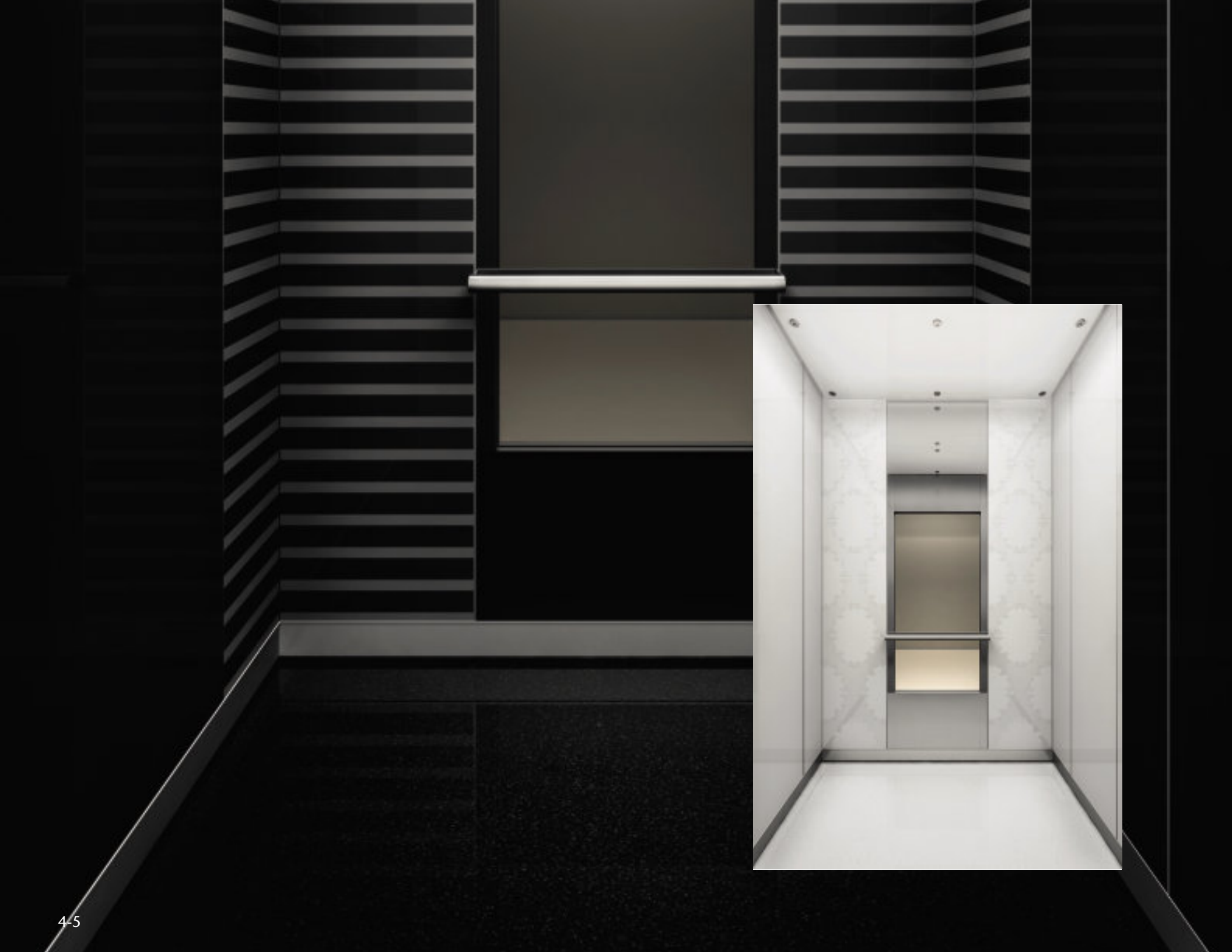





Wood Laminate Winter

Color & Wood Laminate Series

Tradition celebrated

With an emphasis on the back wall, these interiors create the effect of depth and space. The Color Laminate Series interiors fit in fresh modern spaces characterized by details in colors and textures. The Wood Laminate Series follows the same concept but in a more traditional style creating a warm atmosphere.

COLOR LAMINATE SERIES



SPRING

Back Wall

Nirvana (Wilson Art 1792-60)

Side Walls

Pearl Silver LS (Wilson Art D487-07)

Reveal

Brushed Aluminum

Handrail

1.5" Round Satin Stainless Steel

Ceiling

LF-1

Recommended Signalization

Solid Snow White

Recommended Flooring

Taupe Carpet (Van Dijk 18)



SUMMER

Back Wall

Karratha Brush (Wilson Art 4744-60)

Side Walls

Pearl Bisque LS (Wilson Art D485-07)

Reveal

Brushed Aluminum

Handrail

1.5" Round Satin Stainless Steel

Ceiling

LF-1

Recommended Signalization

Solid Plum Red

Recommended Flooring

Natural Beige Carpet (Van Dijk 19)



AUTUMN

Back Wall

Jade Fusion (Wilson Art 1797-07)

Side Walls

Pearl Bisque LS (Wilson Art D485-07)

Reveal

Brushed Aluminum

Handrail

1.5" Round Satin Stainless Steel

Ceiling

LF-94, Satin Stainless Steel

Recommended Signalization

Solid Ivory Black

Recommended Flooring

Forest Carpet (Van Dijk 50)

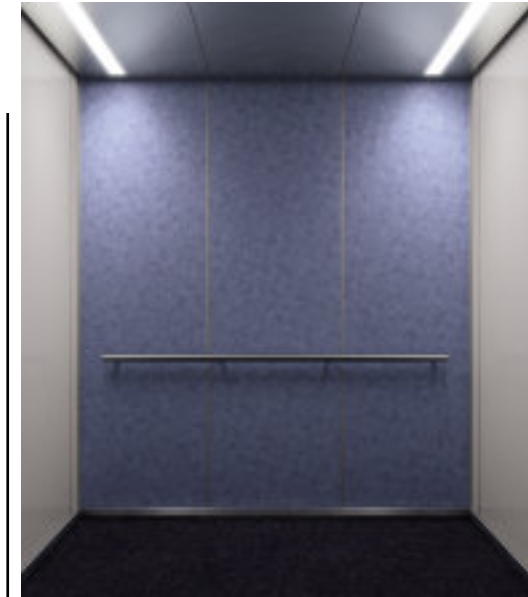

WINTER

Back Wall

Woolamai (Wilson Art 4746-60)

Side Walls

Pearl Silver LS (Wilson Art D487-07)

Reveal

Brushed Aluminum

Handrail

1.5" Round Satin Stainless Steel

Ceiling

LF-94, Satin Stainless Steel

Recommended Signalization

Solid Federal Blue

Recommended Flooring

Midnight Carpet (Van Dijk 43)

For additional wall color options, please contact your KONE Sales Representative.

WOOD LAMINATE SERIES

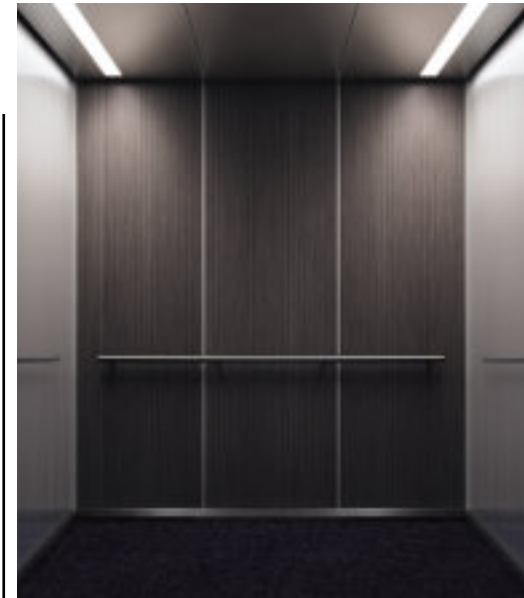
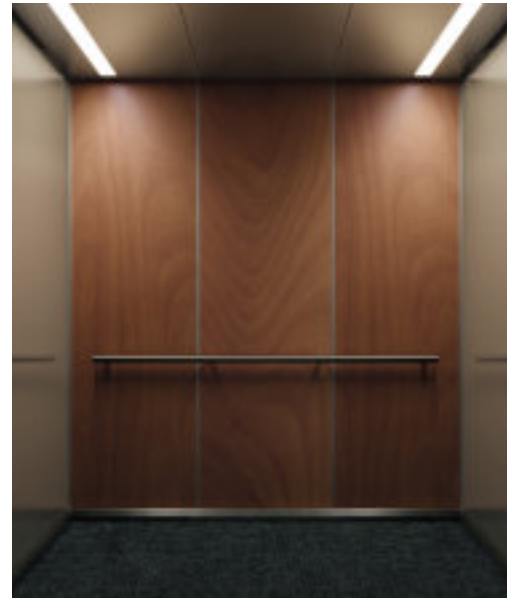

SPRING

- Back Wall**
Beigewood (Wilson Art 7850-60)
- Side Walls**
Satin Brushed Lite Bronze (419)
(Wilson Art 6261)
- Reveal**
Brushed Aluminum
- Handrail**
1.5" Round Satin Stainless Steel
- Ceiling**
LF-1
- Recommended Signalization**
Stones Sand Yellow
- Recommended Flooring**
Taupe Carpet (Van Dijk 18)

SUMMER

- Back Wall**
Amber Cherry (Wilson Art 7919-38)
- Side Walls**
Alumasteel Aluminum (419)
(Wilson Art 6277)
- Reveal**
Brushed Aluminum
- Handrail**
1.5" Round Satin Stainless Steel
- Ceiling**
LF-1
- Recommended Signalization**
Stones Plum Red
- Recommended Flooring**
Natural Beige Carpet (Van Dijk 19)

AUTUMN

- Back Wall**
Wild Cherry (Wilson Art 7054-78)
- Side Walls**
Satin Brushed Lite Bronze (419)
(Wilson Art 6261)
- Reveal**
Brushed Aluminum
- Handrail**
1.5" Round Satin Stainless Steel
- Ceiling**
LF-94, Satin Stainless Steel
- Recommended Signalization**
Stones Moss Green
- Recommended Flooring**
Forest Carpet (Van Dijk 50)

WINTER

- Back Wall**
Asian Night (Wilson Art 7949-38)
- Side Walls**
Alumasteel Aluminum (419)
(Wilson Art 6277)
- Reveal**
Brushed Aluminum
- Handrail**
1.5" Round Satin Stainless Steel
- Ceiling**
LF-94, Satin Stainless Steel
- Recommended Signalization**
Stones Sky Blue
- Recommended Flooring**
Midnight Carpet (Van Dijk 43)

For additional wall color options, please contact your KONE Sales Representative.





Spring

Vintage Series

Longing for the past

Inspired by materials and colors from the era of Art Deco and the International Style, the Vintage Series offers minimal but rich solutions. With special metallic laminates, this series creates both warm and cool ambiances to match buildings with a touch of nostalgia.

The Vintage Series is available for EcoSpace™, MonoSpace and EcoSystem MR. Images shown are applicable for EcoSpace only.

VINTAGE SERIES



SPRING

Back Wall

Satin Brushed Gold Aluminum (419)
(Wilson Art 6258)

Side Walls

Satin Stainless Steel

Reveal

Brushed Aluminum

Handrail

4" Flat Satin Stainless Steel

Ceiling

LF-98, Satin Stainless Steel

Recommended Signalization

Solid Cement Grey

Recommended Flooring

Caratera Snow Polished
(Innovative Stone 02-0173-1013)



SUMMER

Back Wall

Bronze Stria (416)
(Wilson Art 6313)

Side Walls

Satin Stainless Steel

Reveal

Brushed Aluminum

Handrail

4" Flat Satin Stainless Steel

Ceiling

LF-98, Satin Stainless Steel

Recommended Signalization

Solid Plum Red

Recommended Flooring

Holly Red Polished
(Innovative Stone 06-1601-0000)



AUTUMN

Back Wall

Satin Brushed (419)
Medium Bronze Aluminum
(Wilson Art 6262)

Side Wall

Satin Stainless Steel

Reveal

Brushed Aluminum

Handrail

4" Flat Satin Stainless Steel

Ceiling

LF-97, Satin Stainless Steel

Recommended Signalization

Solid Ivory Black

Recommended Flooring

Reynaud Natural
(Innovative Stone 02-1701-0000)



WINTER

Back Wall

Mercury Stria (416)
(Wilson Art 6312)

Side Walls

Satin Stainless Steel

Reveal

Brushed Aluminum

Handrail

4" Flat Satin Stainless Steel

Ceiling

LF-97, Satin Stainless Steel

Recommended Signalization

Solid Federal Blue

Recommended Flooring

Reflective Pond Polished
(Innovative Stone 02-0173-1013)





Summer

Stainless Steel Series

Stainless Steel refined

By combining different textures, finishes and compositions in stainless steel, this series offers new solutions for modern spaces. The interiors create unique effects by the combinations and contrasts of different textures of stainless steel.

The Stainless Steel Series is available for EcoSpace, MonoSpace and EcoSystem MR. Images shown are applicable for EcoSpace only.

STAINLESS STEEL SERIES



SPRING

Back Wall

Back central panel:
Mirror Stainless Steel
Back side panels:
Satin Stainless Steel

Side Walls

Satin Stainless Steel

Handrail

2" Round Satin Stainless Steel

Ceiling

LF-98, Satin Stainless Steel

Recommended Signalization

Solid Snow White or
Lights Snow White

Recommended Flooring

Taupe Carpet (Van Dijk 18)



SUMMER

Back Wall

Back central panel:
Rigidized Metals, Linen
Back side panels:
Mirror Stainless Steel

Side Walls

Satin Stainless Steel

Handrail

2" Round Satin Stainless Steel

Ceiling

LF-98, Satin Stainless Steel

Recommended Signalization

Solid Plum Red or
Lights Fiesta Red

Recommended Flooring

Crimson Carpet (Van Dijk 31)



AUTUMN

Back Wall

Rigidized Metals, Linen

Side Walls

Satin Stainless Steel

Handrail

2" Round Satin Stainless Steel

Ceiling

LF-97, Satin Stainless Steel

Recommended Signalization

Solid Lime Green or
Lights Fresh Green

Recommended Flooring

Forest Carpet (Van Dijk 50)



WINTER

Back Wall

Back central panel:
Satin Stainless Steel
Back side panels:
Mirror Stainless Steel

Side Walls

Satin Stainless Steel

Handrail

2" Round Satin Stainless Steel

Ceiling

LF-97, Satin Stainless Steel

Recommended Signalization

Solid Federal Blue or
Lights Ivory Black

Recommended Flooring

Midnight Carpet (Van Dijk 43)





Spring

Glass Series

Fresh minimalism

The contemporary ambiance of this interior is a perfect match to architectural color as a key component. The bright, solid colors create a dialogue between the overall architecture and the elementary spaces. Or going the other way, the bright interior can act as a source of surprise amidst overall coolness.

The Glass Series is available for EcoSpace, MonoSpace and EcoSystem MR. Images shown are applicable for MonoSpace and EcoSystem MR only.

GLASS SERIES



SPRING

Back Wall

Colored Glass White
(Siberian Glaze GW1)
Frame: Polished Aluminum

Side Walls

Satin Stainless Steel

Reveal

Satin Stainless Steel
behind the raised panels

Handrail

1.5" Round Satin Stainless Steel

Ceiling

LF-98, Satin Stainless Steel

Recommended Signalization

Solid Snow White or
Glasses Citrine Yellow

Recommended Flooring

Caratera Snow Polished
(Innovative Stone 02-0173-1013)



SUMMER

Back Wall

Colored Glass Red
(Tokyo Glaze GW2)
Frame: Polished Aluminum

Side Wall

Satin Stainless Steel

Reveal

Satin Stainless Steel
behind the raised panels

Handrail

1.5" Round Satin Stainless Steel

Ceiling

LF-98, Satin Stainless Steel

Recommended Signalization

Solid Plum Red or
Glasses Agate

Recommended Flooring

Holly Red Polished
(Innovative Stone 06-1601-0000)



AUTUMN

Back Wall
 Colored Glass Yellow
 (Berlin Glaze GW3)
 Frame: Polished Aluminum

Side Wall
 Satin Stainless Steel

Reveal
 Satin Stainless Steel
 behind the raised panels

Handrail
 1.5" Round Satin Stainless Steel

Ceiling
 LF-97, Satin Stainless Steel

Recommended Signalization
 Solid Ivory Black or
 Glasses Malachite Green

Recommended Flooring
 Reynaud Natural
 (Innovative Stone 02-1701-0000)

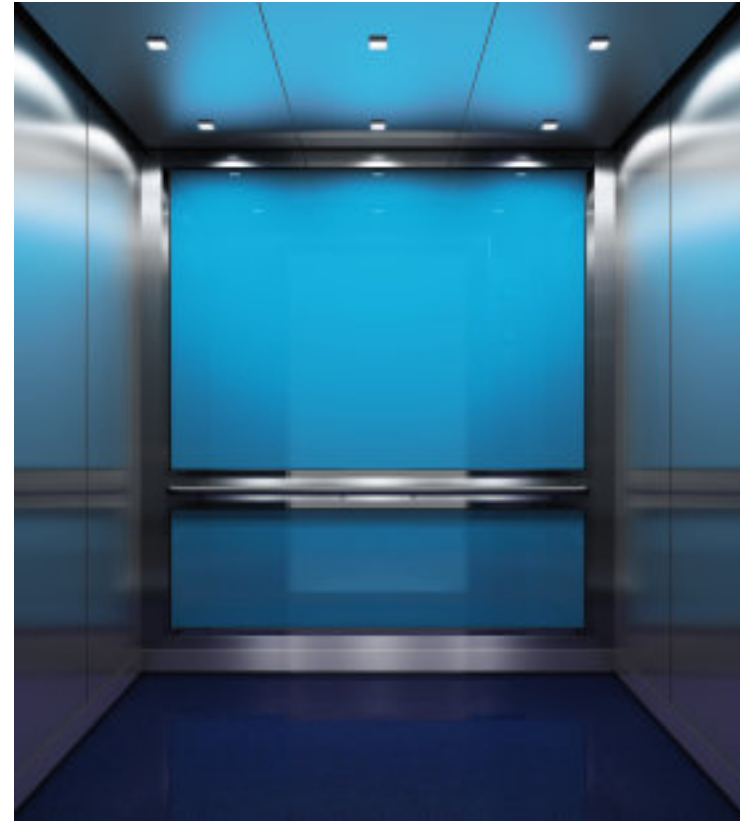

WINTER

Back Wall
 Colored Glass Blue
 (Manhattan Glaze GW4)
 Frame: Polished Aluminum

Side Walls
 Satin Stainless Steel

Reveal
 Satin Stainless Steel
 behind the raised panels

Handrail
 1.5" Round Satin Stainless Steel

Ceiling
 LF-97, Satin Stainless Steel

Recommended Signalization
 Solid Federal Blue or
 Glasses Sapphire Blue

Recommended Flooring
 Reflective Pond Polished
 (Innovative Stone 02-0173-1013)





Landscape Series

Natural luxury

Original recipient of the GOOD DESIGN award, this interior concept was first developed for the European market, particularly for deluxe high-rise buildings. Following its success, we created a collection especially for the North American market, with wood tones that respond to the natural landscapes.

The Landscape Series is available for MonoSpace and EcoSystem MR only.

The KONE FourSeasons Design Collection received the GOOD DESIGN 2008 award, as awarded by The Chicago Athenaeum: Museum of Architecture and Design.

Founded in 1950, GOOD DESIGN is the world's oldest and most celebrated awards program that bestows international recognition upon designers and manufacturers for advancing new and innovative product concepts. GOOD DESIGN criteria measures innovation, form, materials, construction, concept, function and utility.



LANDSCAPE SERIES



SPRING

Back Wall

Back central panel: Bottom and top in Tabu 05.223. Middle in Tabu 52.090.
Panel edges: Black
Back side panels: Mirror Stainless Steel.

Side Walls

Satin Stainless Steel

Reveal

Satin Stainless Steel
behind the raised panels

Handrail

1.5" Round Satin Stainless Steel

Ceiling

LF-88, Satin
Stainless Steel

Recommended Signalization

Solid Snow White

Recommended Flooring

Edinburgh Wine Polished
(Innovative Stone 06-1601-0000)

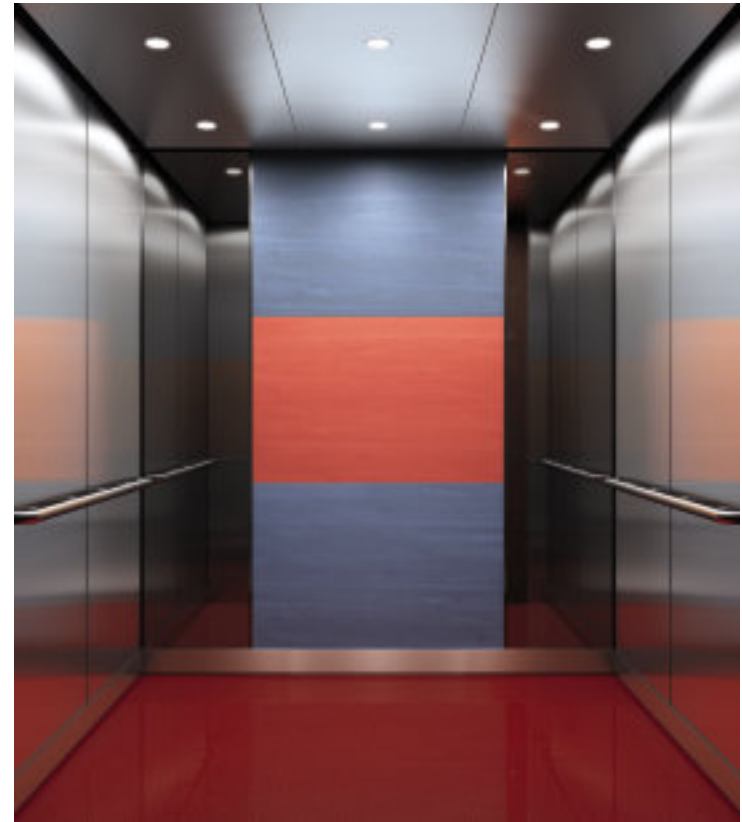

SUMMER

Back Wall

Back central panel: Bottom and top in Tabu 52.067. Middle in Tabu 52.091.
Panel edges: Black
Back side panels: Mirror Stainless Steel.

Side Walls

Satin Stainless Steel

Reveal

Satin Stainless Steel
behind the raised panels

Handrail

1.5" Round Satin Stainless Steel

Ceiling

LF-88, Satin Stainless Steel

Recommended Signalization

Solid Plum Red

Recommended Flooring

Holly Red Polished
(Innovative Stone 06-1601-0000)



AUTUMN

Back Wall

Back central panel: Bottom and top in Tabu 52.071. Middle in Tabu 52.060.
Panel edges: Black
Back side panels: Mirror Stainless Steel.

Side Walls

Satin Stainless Steel

Reveal

Satin Stainless Steel
behind the raised panels

Handrail

1.5" Round Satin Stainless Steel

Ceiling

LF-88, Satin Stainless Steel

Recommended Signalization

Cement Gray

Recommended Flooring

Caratera Sage Polished
(Innovative Stone 02-0173-1013)



WINTER

Back Wall

Back central panel: Bottom and top in Tabu 52.001. Middle in Tabu 52.002.
Panel edges: Black
Back side panels: Mirror Stainless Steel.

Side Walls

Satin Stainless Steel

Reveal

Satin Stainless Steel
behind the raised panels

Handrail

1.5" Round Satin Stainless Steel

Ceiling

LF-88, Satin Stainless Steel

Recommended Signalization

Solid Federal Blue

Recommended Flooring

Reflective Pond Polished
(Innovative Stone 02-0173-1013)





Summer

Panoramic & Horizon Series

Widen the horizon

The Panoramic & Horizon Series were specially developed for the North American market. This Series is a homage to Frank Lloyd Wright, whose architecture was also the source of inspiration. His emphasis on the horizontal design is further developed into an idea to open up the space horizontally.

- **Panoramic Series:** By using wood laminates and opening the top of the space with mirror, these sophisticated interiors fit very well with modernist environments.
- **Horizon Series:** By using pearlescence or metallic laminates, these elevators will bring a sense of surprise and a unique experience to the users of contemporary buildings.

The Panoramic & Horizon Series are available for MonoSpace and EcoSystem MR only.

PANORAMIC SERIES



SPRING

Back and Side Walls
Mirror Stainless Steel
Beigewood
(Wilson Art 7850-60)
Panel edges: Black

Reveal
Mirror Stainless Steel
behind the raised panels

Handrail
1.5" Round Satin Stainless Steel

Ceiling
LF-88, Mirror Stainless Steel

Recommended Signalization
Solid Snow White or
Stones Sand Yellow

Recommended Flooring
Caratera Snow Polished
(Innovative Stone 02-0173-1013)

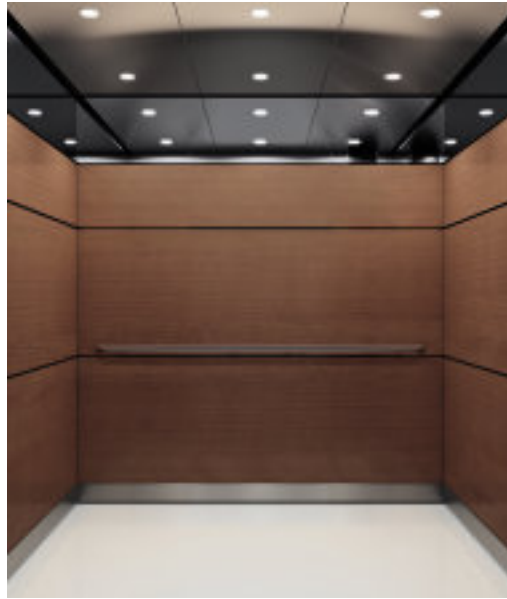

SUMMER

Back and Side Walls
Mirror Stainless Steel
Amber Cherry
(Wilson Art 7919-78)
Panel edges: Black

Reveal
Mirror Stainless Steel
behind the raised panels

Handrail
1.5" Round Satin Stainless Steel

Ceiling
LF-88, Mirror Stainless Steel

Recommended Signalization
Solid Plum Red or
Stones Plum Red

Recommended Flooring
Caratera Snow Polished
(Innovative Stone 02-0173-1013)



AUTUMN

Back and Side Walls
Mirror Stainless Steel
Figured Mahogany
(Wilson Art 7040a-60)
Panel edges: Black

Reveal
Mirror Stainless Steel
behind the raised panels

Handrail
1.5" Round Satin Stainless Steel

Ceiling
LF-97, Mirror Stainless Steel

Recommended Signalization
Solid Ivory Black or
Leaves Plum Red

Recommended Flooring
Caratera Sage Polished
(Innovative Stone 02-0173-1013)



WINTER

Back and Side Walls
Mirror Stainless Steel
Asian Night
(Wilson Art 7949-38)
Panel edges: Black

Reveal
Mirror Stainless Steel
behind the raised panels

Handrail
1.5" Round Satin Stainless Steel

Ceiling
LF-97, Mirror Stainless Steel

Recommended Signalization
Solid Federal Blue or
Leaves Ebony Black

Recommended Flooring
Reflective Pond Polished
(Innovative Stone 02-0173-1013)

For additional wall color options, please contact your KONE Sales Representative.

HORIZON SERIES

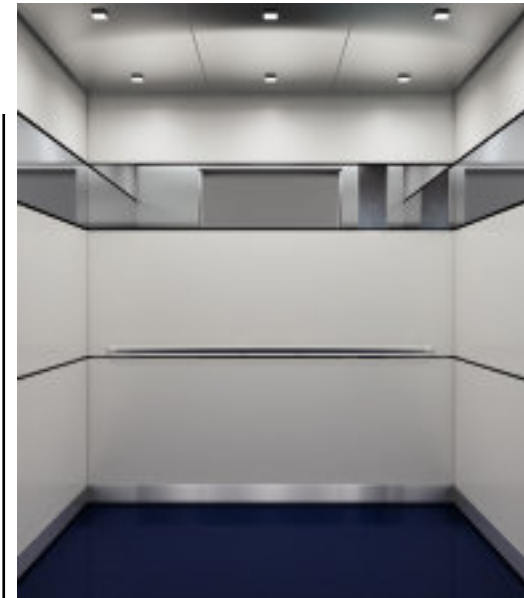
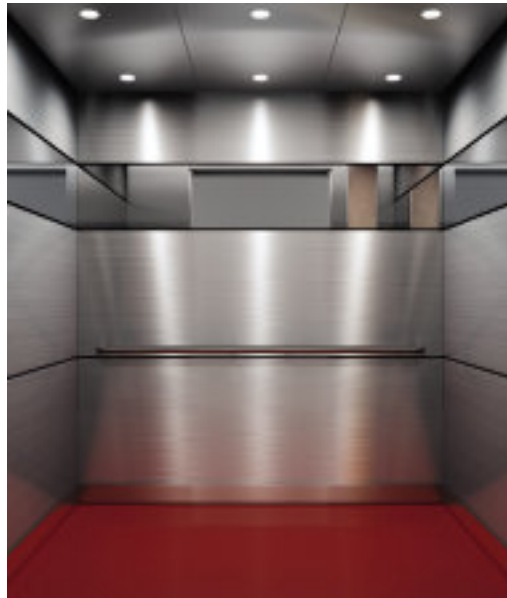

SPRING

Back and Side Walls

Mirror Stainless Steel
 Pearl Bisque LS
 (Wilson Art D485-07)
 Panel edges: Black

Reveal

Mirror Stainless Steel
 behind the raised panels

Handrail

1.5" Round Satin Stainless Steel

Ceiling

LF-88, Satin Stainless Steel

Recommended Signalization

Solid Snow White or
 Lights Snow White

Recommended Flooring

Edinburgh Wine Polished
 (Innovative Stone 06-1601-0000)

SUMMER

Back and Side Walls

Mirror Stainless Steel
 Alumasteel
 (Wilson Art 6277)
 Panel edges: Black

Reveal

Mirror Stainless Steel
 behind the raised panels

Handrail

1.5" Round Satin Stainless Steel

Ceiling

LF-88, Satin Stainless Steel

Recommended Signalization

Solid Plum Red or
 Glasses Agate

Recommended Flooring

Holly Red Polished
 (Innovative Stone 06-1601-0000)

AUTUMN

Back and Side Wall

Mirror Stainless Steel
 Satin Brushed Medium Bronze
 (Wilson Art 6262)
 Panel edges: Black

Reveal

Mirror Stainless Steel
 behind the raised panels

Handrail

1.5" Round Satin Stainless Steel

Ceiling

LF-97, Satin Stainless Steel

Recommended Signalization

Solid Ivory Black or
 Lights Ivory Black

Recommended Flooring

Caratera Sage Polished
 (Innovative Stone 02-0173-1013)

WINTER

Back and Side Walls

Mirror Stainless Steel
 Pearl Silver LS
 (Wilson Art D487-07)
 Panel edges: Black

Reveal

Mirror Stainless Steel
 behind the raised panels

Handrail

1.5" Round Satin Stainless Steel

Ceiling

LF-97, Satin Stainless Steel

Recommended Signalization

Solid Federal Blue or
 Glasses Sapphire Blue

Recommended Flooring

Reflective Pond Polished
 (Innovative Stone 02-0173-1013)

For additional wall color options, please contact your KONE Sales Representative.

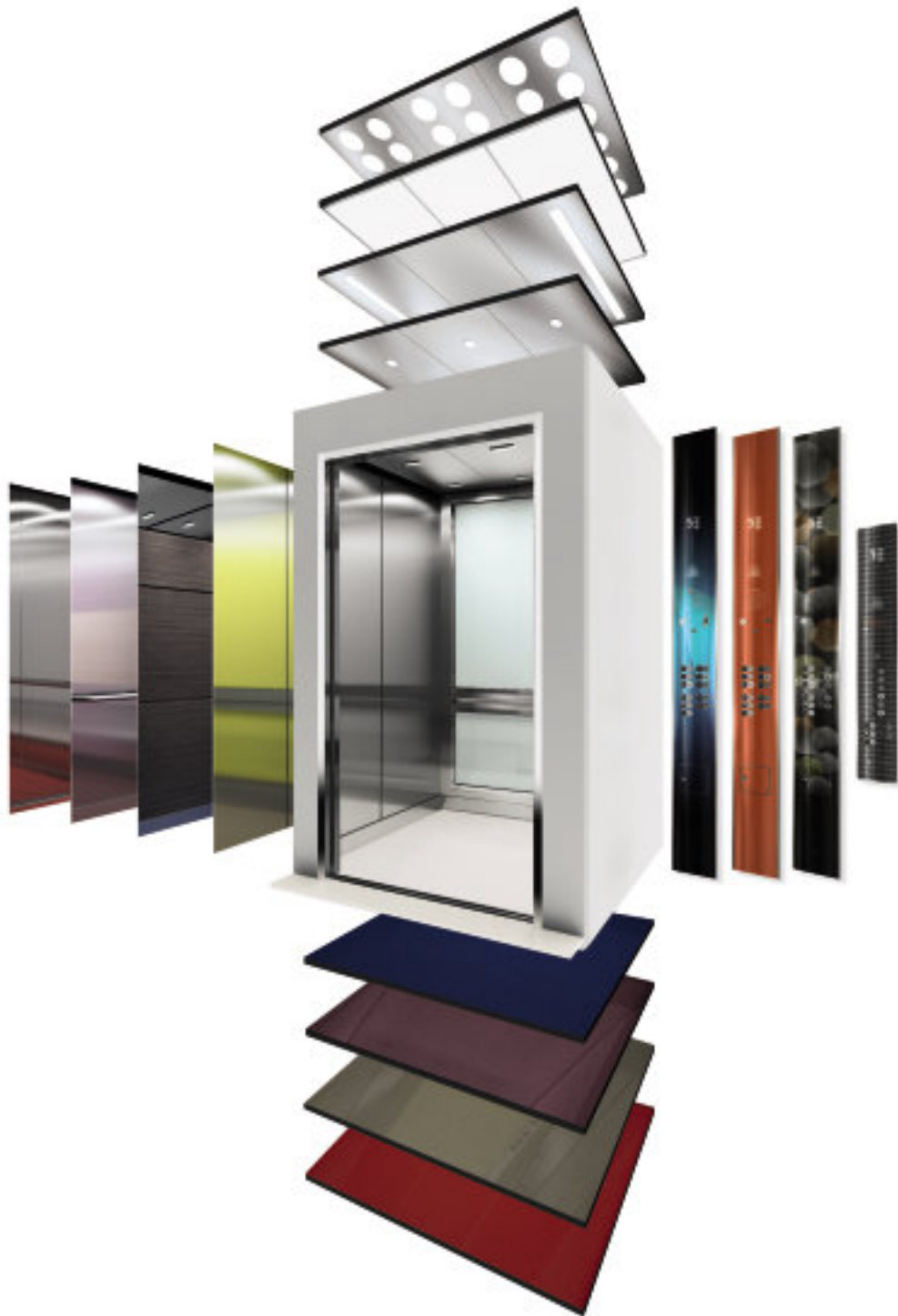

Mix & Match

If you can't find exactly what you're looking for from our KONE Design Collection interiors, you can replace elements with alternatives from the range. Select ceilings, walls, doors, handrails and flooring. There are thousands of possible combinations.

By utilizing the special aspects of the KONE Design Signalization Collection, implementing corporate logos, tenant directories, extended floor names and customer-provided backgrounds can be seamlessly integrated into the visual outlook of your car operating panel.

With these materials, KONE has created a harmonious whole where all parts work together. As a result, a harmonious elevator design is created: a positive user experience aesthetically, functionally and emotionally.

Visit www.kone.com for the latest job-specific Cab Designer Tool, CAD drawings and specifications.

KONE DESIGN SIGNALIZATION

HALL LANTERNS



HALL STATIONS



Plum Red Federal Blue Cement Gray Ivory Black Snow White



Lime Green Fiesta Red Beach Blue Fresh Green Sand Yellow



Partial height Car Operating Panel with custom designed faceplate



The KONE Design Collection was awarded a 2009 GOOD DESIGN award for the KONE Design Signalization series. KONE is the only elevator and escalator company to have ever received a GOOD DESIGN award in 60 years.

GOOD DESIGN was founded in 1950. It is renowned as one of the most recognized design awards program in the world. Awards are given by The Chicago Athenaeum and The European Center for Architecture Art Design and Urban Studies to recognize the best new designs and design innovations for products and graphics which were made between 2007 and 2009.

Car Operating Panel offerings are also available in partial height.
Leaves are only available in full height.

KONE DESIGN SIGNALIZATION

STONES



GLASSES



LIGHTS



SOLID COLORS



SOLID COLORS / NEON

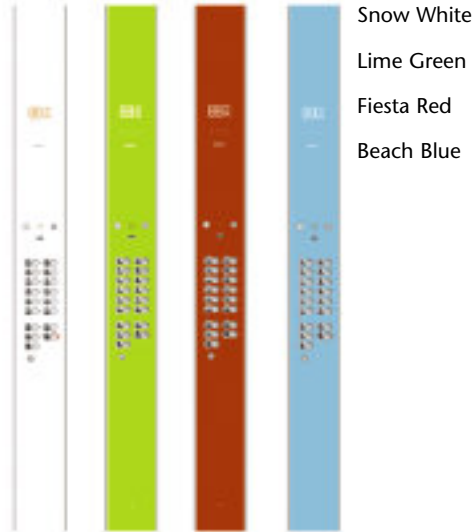

LEAVES



KSS370



Face Plate Material: Stainless steel
Face Plate Finish: Satin
Shape: Rectangle
Displays: Amber dot matrix
Buttons: Round with amber acceptance light

KSS500



Face Plate Material: Stainless steel or bronze
Face Plate Finish: Satin or mirrored
Shape: Rectangle
Displays: White or amber dot matrix
Buttons: Round with amber or white call acceptance light

KSS600

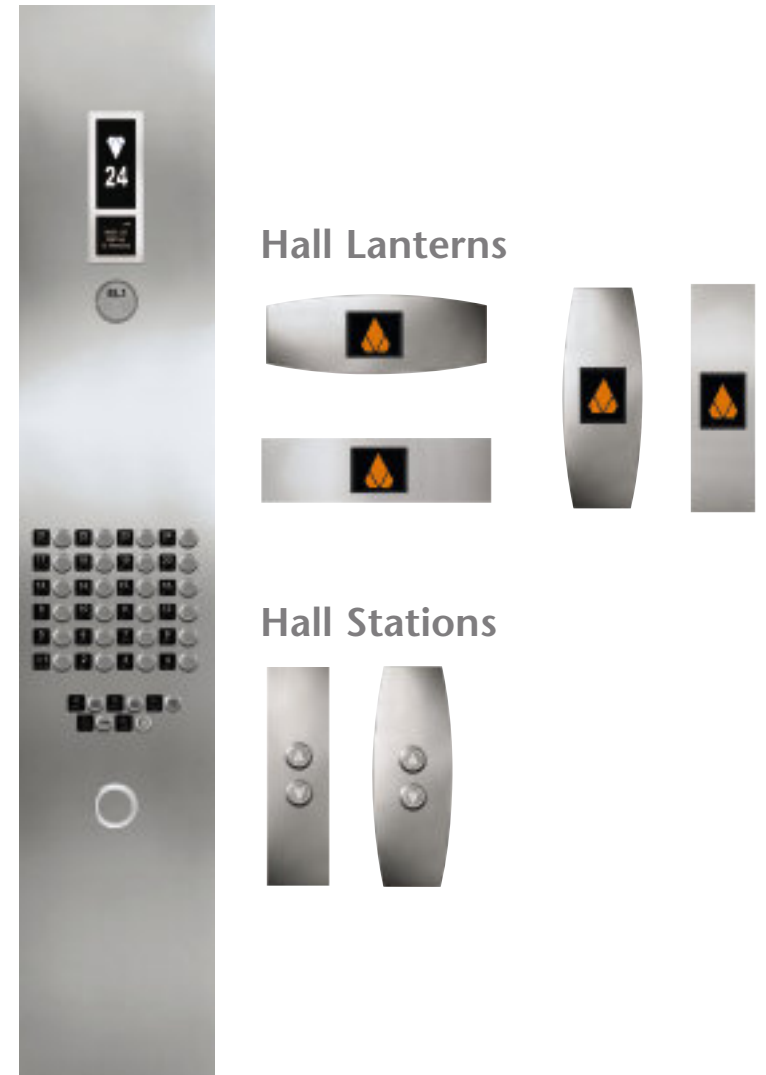

Face Plate Material: Stainless steel or bronze
Face Plate Finish: Satin or mirrored
Displays: White or amber dot matrix, or white LCD
Buttons: Round with amber or white call acceptance light
Mounting: Integral swing or surface mounted

CEILINGS



LF-1

Panels
Polygal Translucent

Frame
Brushed Aluminum

Lighting
T-5 Fluorescent



LF-2

Panels
Stainless Steel with Satin Finish

Lighting
T-5 Fluorescent



LF-94

Panels
Stainless Steel with Satin Finish

Lighting
T-5 Fluorescent

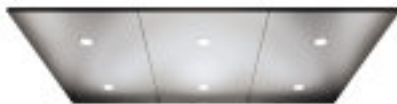

LF-88

Panels
Stainless Steel or Bronze with Satin or Mirror Finish*

Lighting
Round LED**



LF-97

Panels
Stainless Steel or Bronze with Satin or Mirror Finish*

Lighting
Square LED**



LF-98

Panels
Stainless Steel or Bronze with Satin or Mirror Finish*

Lighting
Rectangular LED**

*EcoSpace available in Stainless Steel with a Satin Finish only.

**Six light fixtures for Passenger Shape and nine light fixtures for Service Shape.

LANDING DOORS

KONE offers three styles of doors – single-slide, center-opening and two-speed side opening. These can be matched with different frames and finishes to accommodate a variety of building types and traffic patterns. Contact your local KONE Sales Professional who can assist you in determining the ideal arrangement for your particular needs.



Single-Slide Door

Finish
 Painted finish
 Satin stainless steel
 Mirror stainless steel
 Satin bronze
 Mirror bronze*

Note
 Single-slide doors make the most efficient use of cab space.

Doors are available in 7', 8' or 9' heights.



Center-Opening Door

Finish
 Painted finish
 Satin stainless steel
 Mirror stainless steel
 Satin bronze
 Mirror bronze*

Note
 This higher-performance door is suitable for high-traffic applications.

Doors are available in 7', 8' or 9' heights.



Two-Speed Side Opening Door

Finish
 Painted finish
 Satin stainless steel
 Mirror stainless steel
 Satin bronze
 Mirror bronze*

Note
 Two-speed doors are best suited for deep and narrow cab configurations.

These doors are appropriate for use in hospitals or other locations where tenants may need to move carts, furniture or other large objects.

Doors are available in 7', 8' or 9' heights.

*Available for MonoSpace and EcoSystem MR only.

HANDRAILS

MonoSpace and EcoSystem MR



1.5" Round in Stainless Steel with Satin finish



2" Flat in Stainless Steel with Satin finish

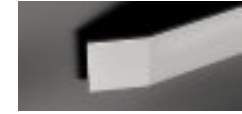

4" Flat in Stainless Steel with Satin finish

EcoSpace



1.5" Round in Brushed Aluminum, Stainless Steel with Satin finish



2" Round in Stainless Steel with Satin finish



1.5" Flat in Stainless Steel with Satin finish



2" Flat in Stainless Steel with Satin finish



3" Flat in Stainless Steel with Satin finish

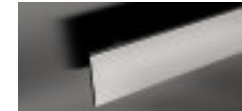

4" Flat in Stainless Steel with Satin finish

SKIRTING



MonoSpace EcoSystem MR

Stainless Steel or Bronze with Satin or Mirror finish



EcoSpace

Stainless Steel with Satin finish



U.S. Operations Center

One KONE Court
Moline, Illinois 61265
1-800-956-KONE (5663)

Canadian Operations Center

80 Horner Avenue
Toronto, Ontario M8Z 4X8
1-416-252-6151

KONE Mexico, S.A. de C.V.

Clavel 227
Colonia Atlampa
Mexico City, D.F. 06450
+52.55.1946.0100

For the latest product information
and interactive design tools, visit
www.us.kone.com

KONE Inc. reserves the right to alter design
and specifications without prior notice.

KONE and MonoSpace are registered
trademarks of KONE Inc. Dedicated to
People Flow, EcoSpace, EcoSystem MR and
FourSeasons are trademarks of KONE Inc.

"USGBC" and related logo is a trademark
owned by the U.S. Green Building Council
and is used by permission.

GOOD DESIGN is a registered trademark of
The Chicago Athenaeum: Museum of
Architecture and Design.

U.S. Offices

Alabama
Birmingham 205-944-1032
Mobile 251-661-7522

Arizona
Phoenix 602-269-7877
Tucson 520-624-3125

Arkansas
Little Rock 501-758-1889

California
Los Angeles 562-921-1555
Sacramento 916-372-1458
San Diego 858-679-2400
San Francisco 510-351-5141
Santa Barbara 805-349-1013

Colorado
Denver 303-792-3423

Connecticut
Hartford 860-257-9277

Delaware 856-251-1555

District of Columbia
Washington, DC 301-459-8660

Florida
Jacksonville 904-292-0225
Miami 954-437-4300
Naples 239-598-9310
Orlando 407-812-8033
Tampa 813-635-0330

Georgia
Atlanta 770-427-3373

Hawaii
Honolulu 808-836-2231

Idaho 801-977-1144

Illinois
Chicago 630-629-3100
Peoria 309-697-9011
Quad Cities 309-797-3232
Rockford 815-874-1502

Indiana
Fort Wayne 260-484-9586
Indianapolis 317-788-0061

Iowa
Des Moines 515-243-0109
Quad Cities 309-797-3232

Kansas
Wichita 316-942-1201

Kentucky
Louisville 502-491-0565

Louisiana
Baton Rouge 225-291-5270
New Orleans 504-736-0776

Maine 781-828-6355

Maryland
Baltimore 410-766-2100

Massachusetts
Boston 781-828-6355

Michigan
Detroit 734-513-6944
Grand Rapids 616-534-3300

Minnesota
Minneapolis 651-452-8062

Mississippi
Jackson 601-939-7597

Missouri
Kansas City 816-531-2140
St. Louis 314-521-8800
Springfield 417-862-1174

Montana
Helena 406-449-1399

Nebraska
Omaha 402-592-7381

Nevada
Las Vegas 702-269-0919

New Hampshire 781-828-6355

New Jersey
High Bridge 908-638-6881

New Mexico
Albuquerque 505-888-0626

New York
Albany 518-464-0002
New York City 718-361-7200

North Carolina
Charlotte 704-597-0430

North Dakota 651-452-8062

Ohio
Cincinnati 513-755-6195
Cleveland 440-546-1100
Columbus 614-866-1751

Oklahoma
Oklahoma City 405-682-5651
Tulsa 918-258-0582

Oregon
Portland 503-652-1011

Pennsylvania
Harrisburg 717-653-7177
Philadelphia 856-488-8830
Pittsburgh 412-279-1561

Rhode Island 781-828-6355

South Carolina 704-597-0430

South Dakota
Sioux Falls 605-336-1578

Tennessee
Knoxville 865-938-3444
Memphis 901-758-8320
Nashville 615-360-7013

Texas
Austin 512-443-0967
Dallas 469-549-0581
Houston 281-442-6619
San Antonio 210-491-0485

Utah
Salt Lake City 801-977-1144

Vermont 781-828-6355

Virginia
Richmond 804-328-1032

Washington
Seattle 425-861-9696

West Virginia
Charleston 614-866-1751
Morgantown 412-279-1561

Wisconsin
Milwaukee 262-373-0460

Wyoming 303-792-3423

Canada Offices

Alberta
Calgary 403-275-5650
Edmonton 780-452-9227

British Columbia
Vancouver 604-777-5663
Victoria 250-384-0613
Kelowna 250-491-1838

Manitoba
Winnipeg 204-895-2942

Nova Scotia
Halifax 902-450-1102

Ontario
Hamilton 905-648-3188
Kingston 613-531-6262
Ottawa 613-225-8222
Toronto 905-948-2230

Quebec
Montreal 514-284-2025
Quebec City 418-877-1494
Sherbrooke 819-821-2182

