

KONE provides innovative and efficient solutions for elevators, escalators and automatic building doors. We support our customers every step of the way; from design, manufacturing and installation to maintenance and modernization. KONE is a global leader in helping our customers manage the smooth flow of people and goods throughout their buildings.

Our commitment to customers is present in all KONE solutions. This makes us a reliable partner throughout the life cycle of the building. We challenge the conventional wisdom of the industry. We are fast, flexible, and we have a well-deserved reputation as a technology leader, with such innovations as KONE MonoSpace®, KONE MacSpace™, and KONE InnoTrack™. You can experience these innovations in architectural landmarks such as the Trump Tower in Chicago, the 30 St Mary Axe building in London, the Schiphol Airport in Amsterdam and the Beijing National Grand Theatre in China.

KONE employs over 30,000 dedicated experts to serve you globally and locally in 49 countries.

KONE Elevator India Private Limited

Registered Office and Factory
50, Vanagaram Road, Ayanambakkam
Chennai - 600 095, India
Tel. No. +91 44 26533901 - 04
Fax No. +91 44 26533912
Contact person:
Tel. No.:

Visit us at www.kone.com



A GEARED MACHINE ROOM ELEVATOR SOLUTION FOR LOW AND MID RISE RESIDENTIAL BUILDINGS

KONE Swift



KONE Swift – Three cheers to meet the needs of the building and your budget!

KONE Swift (MDS) – Manual door, single speed
KONE Swift (MDV) – Manual door with V3F Drive
KONE Swift (ADV) – Automatic door with V3F Drive

The KONE Swift elevator is designed for a smooth, comfortable, safe ride in low and mid-rise buildings, with a maximum travel of 35 meters and maximum load of 680kg (10 passengers).

KONE Swift (MDS)

- Manual Door
- Cost effective single-speed drive
- Proven safety and reliability
- Attractive aesthetics
- Quick delivery and installation
- Speed: 0.6 m/s
- Maximum number of stops: 12
- Maximum travel: 35 m
- Maximum load: 408 kg
- Capacity: 4,5 and 6 persons

KONE Swift (MDV)

- Manual Door
- Energy efficient V3F drive
- Proven safety and reliability
- Attractive aesthetics
- Quick delivery and installation
- Smooth, quiet, comfortable ride
- Speed: 0.6 m/s
- Maximum number of stops: 12
- Maximum travel: 35 m
- Maximum load: 680 kg
- Capacity: 4,5,6,8 and 10 persons

KONE Swift (ADV)

- Automatic Door
- Energy efficient V3F drive
- Proven safety and reliability
- Attractive aesthetics
- Quick delivery and installation
- Smooth, quiet, comfortable ride
- Speed: 0.6 m/s
- Maximum number of stops: 12
- Maximum travel: 35 m
- Maximum load: 680 kg
- Capacity: 4,5,6,8 and 10 persons
- Grouping: up to 2



Depending on your budget, the shaft size and the lobby size, you can choose the type of door for your elevator that best fits your needs.

KONE Swift (ADV)

Car and Landing Door
Centre Opening Automatic Power Doors (COPD)

KONE Swift (MDS/MDV)

Car Door

Side Opening Manual Sliding Door (SOMD)
Imperforated Gate (IFG)
Full Midbar Collapsible Gate (FMBC)

Landing Door

Side Opening Manual Sliding Door (SOMD)
Metal Swing Door (SD)
Imperforated Gate (IFG)
Full Midbar Collapsible Gate (FMBC)
(Collapsible gates are not permitted in some states)

KONE Swift Features and Doors

KONE offers Down Collective Control as a standard. This means that your call is registered in the memory when the button is pressed and you do not have to wait to close the door or for the elevator to become free as in conventional push button controls.

KONE Swift (MDV/ADV) incorporates the latest variable voltage variable frequency (VVF) technology to provide utmost reliability and affordability. The V3F Drive results in good ride comfort with 50% energy saving as compared to single speed elevators. Kone's unique Load Compensation feature ensures good leveling accuracy.

When the gate is left open in the manual door elevators the Gate Open Warning Buzzer comes in handy. This feature is possible because KONE has provided a double contact electro mechanical door lock as a standard.

KONE offers an Electronic Constant Voltage Circuit to mitigate perennial power supply problems with low and high voltage and faulty neutral. This is available as a standard in Swift (MDS/MDV) and as an option in Swift (ADV).

KONE Rescue Device (KRD) is another optional safety feature. In the case of power failure this battery operated automatic rescue device brings the elevator to the nearest floor, enabling safe exit of passengers.

KONE offers Emergency Light Inverter for car light and alarm as a standard in elevators with IFG, SOMD, SD or COPD doors.

KONE Automatic doors (COPD) are always provided with full length Light Curtain as a standard feature enabling safe access for the children and the elderly.



Manual sliding door (SOMD)



Collapsible gate (FMBC)



Automatic door (COPD)



Imperforated gate (IFG)



Swing door (SD)



Curtain of light



Swift Spring
Coral red and Silver Grey panels



Swift Summer
Reed Green and Silver Grey panels



Swift Monsoon
Saffron Yellow and Silver Grey panels



Swift Winter
Pigeon Blue and Silver Grey panels

A pleasing ambience awaits you

The decor of an elevator should complement the ambience of its building's interior. KONE Swift offers a choice of four cars in bright and neutral colours to match the decor of the building and designed to please your senses.

Quality materials

Walls
Painted Steel Panels

Floor
PVC

Car Operating Panel
KDS50 buttons with red registration LEDs on stainless steel face plate.
Seven segment indicator in Chrome finished inclined module on lintel.

Handrail
Silver grey or Matt Black painted

Ceiling
Painted steel

Lighting
Direct CFL Lights

Ventilation
Round axial fan with black frame

Mirror
Partial height, full width



Attractive and user-friendly



Made of brushed stainless steel, the landing call station and car operating panels are easy to read and easy to operate. Their attractive finish and design upgrade the KONE Swift's interior and harmonize with the ambience of the surroundings.

CAR OPERATING PANEL

The car operating panel includes the button interface needed by the passenger. Car position indicator is provided as a standard and is mounted on the lintel for a clear view.

LANDING SIGNALIZATION

Landing call stations with direction arrows mounted on the wall is standard for Swift (MDS/MDV). Landing position indicator is standard for Swift (ADV) and optional for Swift (MDS/MDV).

KONE Swift planning guide

The planning guide for the KONE Swift gives you the dimensions of the elevator cars and their shafts to help you select the configuration that matches specified capacities, fits in with available space and is compatible with your building's design.

The dimensions of the elevator shafts include entrance height, car interior height, pit height, maximum travel and headroom. The table indicates different configurations offered for the KONE Swift cars and their shafts. Loads range from 4 persons or 272 kg to 10 persons or 680 kg. Based on your space requirements and specific loads, you can choose the configuration most suited to your needs.

The KONE Swift can be arranged in groups of two elevators for maximum traffic flow between floors. KONE can analyze the traffic conditions in your building and recommend the optimum elevator configuration. For more details contact our Sales Engineer.

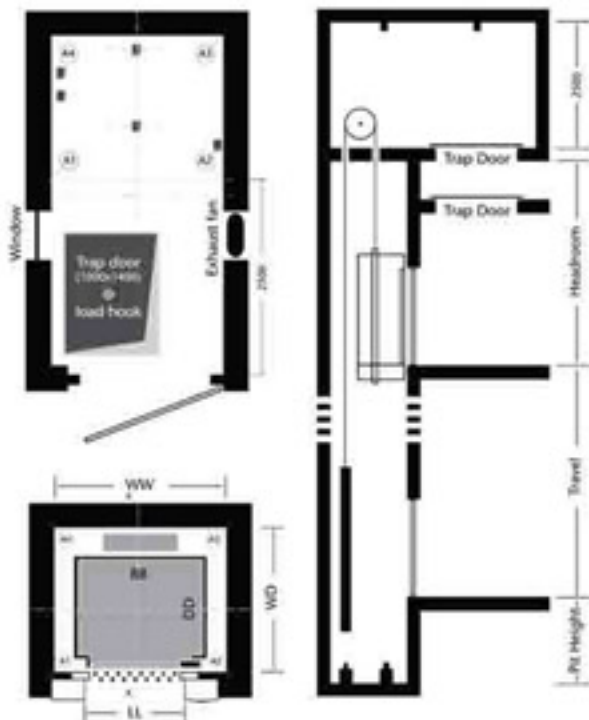

Common Data

Rated Speed 0.6m/s
 Car Interior Height CH 2200mm
 Door Height 2000 mm
 Headroom Height 3800 mm
 Pit Height 1350 mm

Note

All shaft measurement specified are taken over plaster and are minimum dimensions
 Shaft dimensions are to be maintained to a tolerance of 0, +25mm
 The Relevant local regulations in respective states have to be considered
 All dimensions are in mm

Car and Shaft Dimensions

Capacity in persons	Car Size in mm BB x DD	Car Door	Land Door	LL (mm)	Shaft Dimensions in mm WW x WD
4	1100 x 700	SOMD	SOMD	750	1500 x 1250
5	1100 x 850	SOMD	SOMD	750	1500 x 1400
5	1200 x 800(N)	SOMD	SOMD	750	1600 x 1350
6	1100 x 1000	SOMD	SOMD	750	1500 x 1550
6	1200 x 900(N)	SOMD	SOMD	750	1600 x 1450
8	1300 x 1100	SOMD	SOMD	750	1700 x 1650
8	1100 x 1300(N)	SOMD	SOMD	750	1500 x 1850
10	1300 x 1350	SOMD	SOMD	750	1700 x 1900
10	1000 x 1800(N)	SOMD	SOMD	750	1700 x 2250
4	1100 x 700	SOMD	SD	750	1600 x 1150
5	1100 x 850	SOMD	SD	750	1600 x 1300
5	1200 x 800(N)	SOMD	SD	750	1600 x 1250
6	1100 x 1000	SOMD	SD	750	1600 x 1450
6	1200 x 900(N)	SOMD	SD	750	1600 x 1350
8	1300 x 1100	SOMD	SD	750	1700 x 1550
8	1100 x 1300(N)	SOMD	SD	750	1600 x 1750
10	1300 x 1350	SOMD	SD	750	1700 x 1800
10	1000 x 1800(N)	SOMD	SD	750	1700 x 2100
4	1100 x 700	FMBC/IFG	FMBC/IFG/SD	800*	1550** x 1100
5	1100 x 850	FMBC/IFG	FMBC/IFG/SD	800*	1550** x 1250
6	1100 x 1000	FMBC/IFG	FMBC/IFG/SD	800*	1550** x 1400
8	1300 x 1100	FMBC/IFG	FMBC/IFG/SD	800*	1700 x 1500
10	1300 x 1350	FMBC/IFG	FMBC/IFG/SD	800*	1700 x 1750
4	900 x 850(N)	FMBC/IFG	FMBC/IFG/SD	800*	1450** x 1250
5	850 x 1100(N)	FMBC/IFG	FMBC/IFG/SD	800*	1400** x 1500
5	1200 x 800(N)	FMBC/IFG	FMBC/IFG/SD	800*	1600 x 1200
6	850 x 1250(N)	FMBC/IFG	FMBC/IFG/SD	800*	1400** x 1650
6	1200 x 900(N)	FMBC/IFG	FMBC/IFG/SD	800*	1600 x 1300
8	1100 x 1300(N)	FMBC/IFG	FMBC/IFG/SD	800*	1550** x 1700
10	1000 x 1800(N)	FMBC/IFG	FMBC/IFG/SD	800*	1700 x 2100
4	1100 x 700	COPD	COPD	700	1550 x 1250
4	1100 x 700	COPD	COPD	800	1750 x 1250
5	1100 x 850	COPD	COPD	700	1550 x 1400
5	1100 x 850	COPD	COPD	800	1750 x 1400
5	1200 x 800(N)	COPD	COPD	700	1600 x 1350
5	1200 x 800(N)	COPD	COPD	800	1750 x 1350
6	1100 x 1000	COPD	COPD	700	1550 x 1550
6	1100 x 1000	COPD	COPD	800	1750 x 1550
6	1200 x 900(N)	COPD	COPD	700	1600 x 1450
6	1200 x 900(N)	COPD	COPD	800	1750 x 1450
8	1300 x 1100	COPD	COPD	800	1750 x 1650
8	1100 x 1300(N)	COPD	COPD	700	1550 x 1850
8	1100 x 1300(N)	COPD	COPD	800	1750 x 1850
10	1300 x 1350	COPD	COPD	800	1750 x 1900

* for IFG and SOMD LL = 750mm only

** Dimension given is for SD in landing. For FMBC & IFG in landing this dimension will be less by 50mm

(N) Non standard car sizes (which are different to car dimensions in Indian Standards)